

► Float Sensor

FS8- 88 N Series

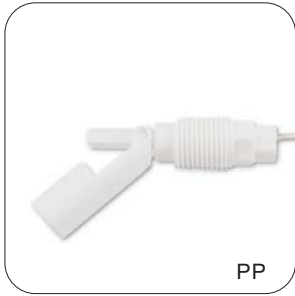

PVDF



PP

► Switch Specifications of 88N Series

Characteristics	Contact Type	Unit	(0) Normal Open	(1) High Power	(2) Normal Close	(8) High Voltage
• Contact Rating (max)		W	10	70	3	20
• Switching Voltage DC (max)		V	200	200	30	350
• Switching Voltage AC (max)		V	150	250	30	240
• Switching Current (max)		mA	500	1000	200	500
• Carry Current (max)		A	1.0	1.75	0.5	1.5
• Breakdown Voltage (min)		V	250	400	200	600
• Contact Resistance (max)		mΩ	120	150	200	120
• Operating Temperature (max)		°C	-20~80	-20~80	-20~80	-20~80

► Switch Types

Table 1

	White White		Red White		Red Red		Gray White
0 : Normal Open - A Type		1 : Normal Open - A Type Hi Power		2 : Normal Close B - Type		8 : Normal Open - A Type Hi Voltage	

► Dimensions

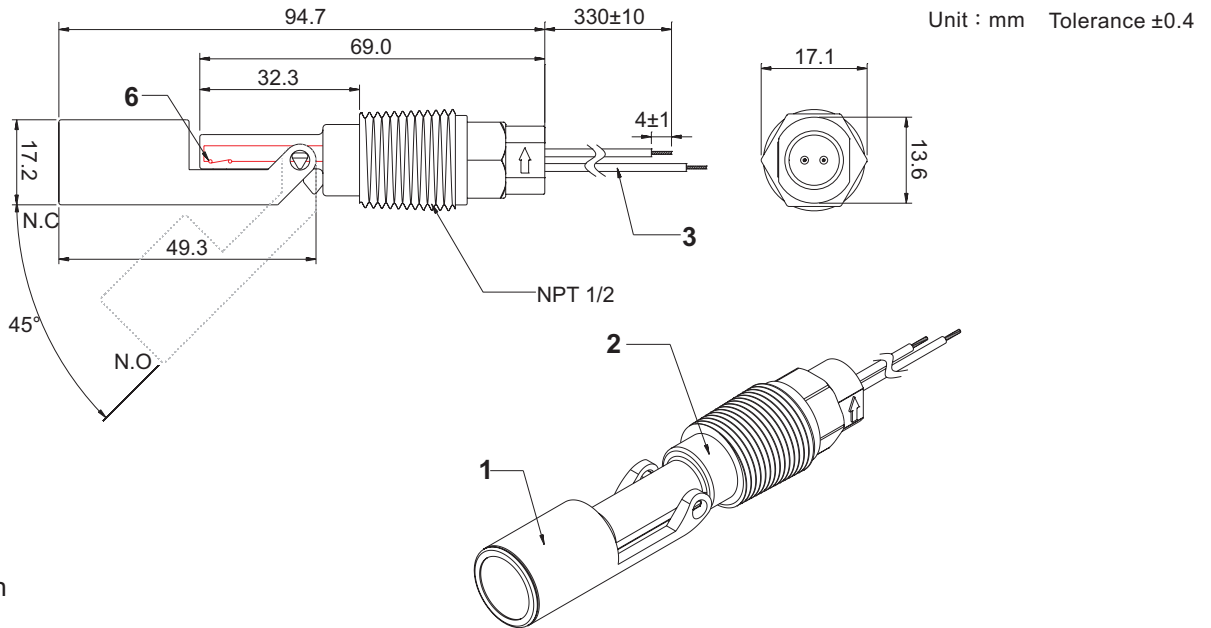

► Structure

1. Float
2. Body
3. Wire
4. Reed Switch

► Plastic Properties

Table 2

Property	Float Specific gravity	Water absorption	Rockwell Hardness	Izod impact strength	Heat distorti temperatures
Material					
PP	0.58	1.4 % (ASTM D955)	97 R Scale (ASTM D785)	3.5 Kg-Cm/Cm (ASTM D256)	98 °C (ASTM D648)
PVDF	0.95	---	80 D (ISO 868)	120 J/m (ISO 180)	108 °C (ISO 75)
ABS	0.67	0.3-0.6 % (ASTM D955)	102 R Scale (ASTM D785)	40Kg-Cm/Cm (ASTM D256)	87 °C (ASTM D648)
Test Conditions	---	---	---	23°C(73°F)	18.6kg/cm <sup>2</sup> (264 psi)

► Wire Specifications

Table 3

Material	Series	Description	Diagram
PVC or PVDF	Normal	Tinned leads	
PVC or PVDF	Cont	JST XH2.5	

► Ordering Information

A Complete part number is represented by the digits below :

FS8-88 - X N - XX H XX XX

- ① : Switch Type - Table 1 (0,1,2,8)
- ② : Material - Table 2 (PP=PP;PF=PVDF)
- ③ : Wire Specifications - Table 3 - Material(PV=PVC ; PF=PVDF) - Series(NO= Normal ; CN=Cont)

☆☆☆ The wires are not aligned at the end ☆☆☆